

Montageanleitung / Assembly instruction / Notice de montage

Parallelarm / Parallel arm / Bras parallèle mit / with / avec TS-50/20 (RFG)

DIN links / left / gauche
 DIN rechts (spiegelbildlich)
 DIN right (mirror image)
 DIN droite (image inversée)

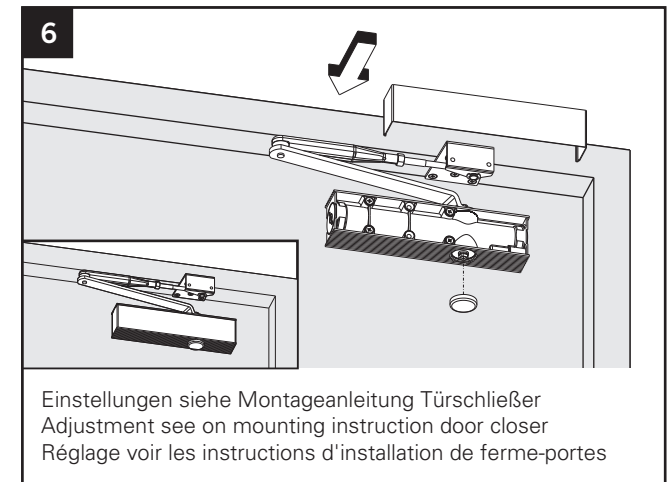
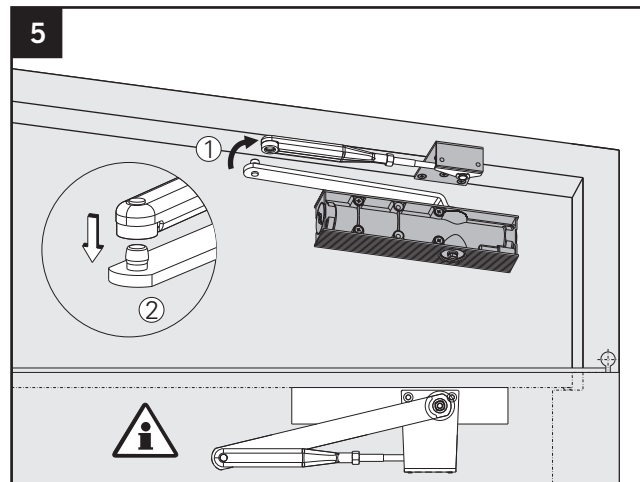
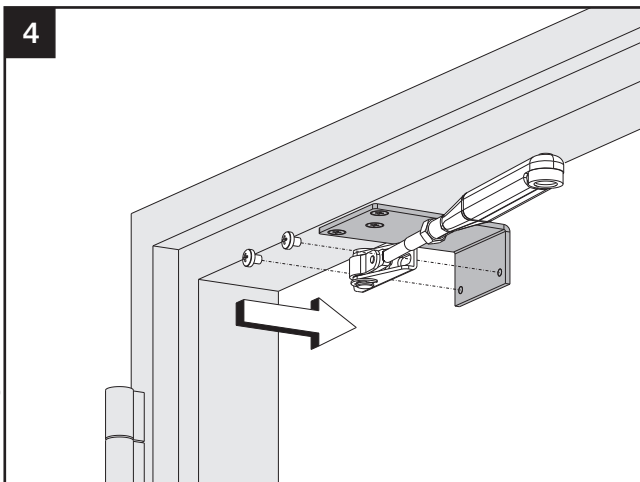
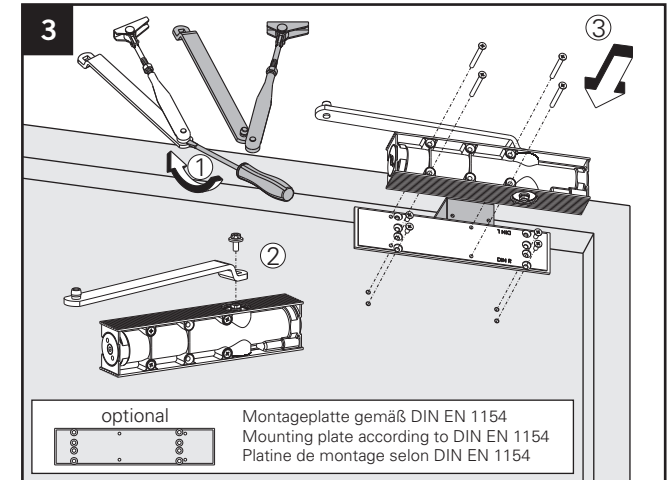
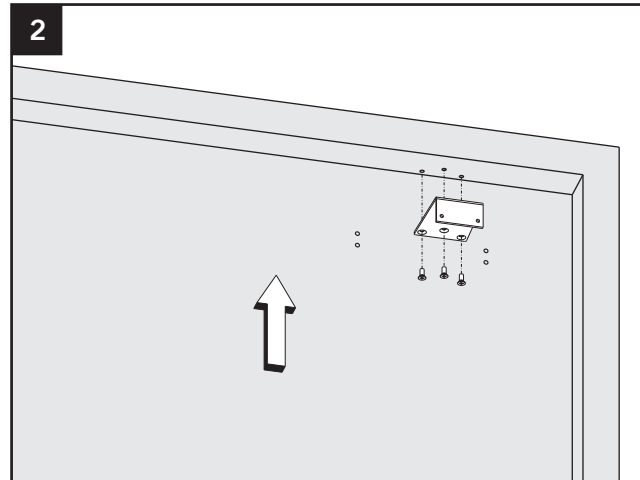
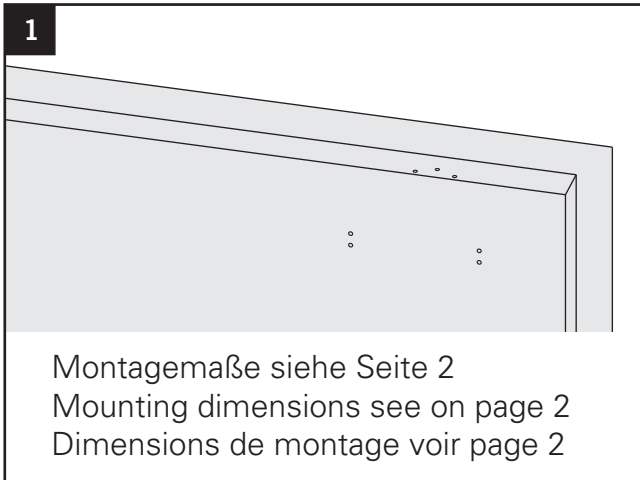

Montageanleitung / Assembly instruction / Notice de montage

Parallelarm / Parallel arm / Bras parallèle mit / with / avec **TS-50/20 (RFG)**

DIN links / left / gauche
 DIN rechts (spiegelbildlich)
 DIN right (mirror image)
 DIN droite (image inversée)

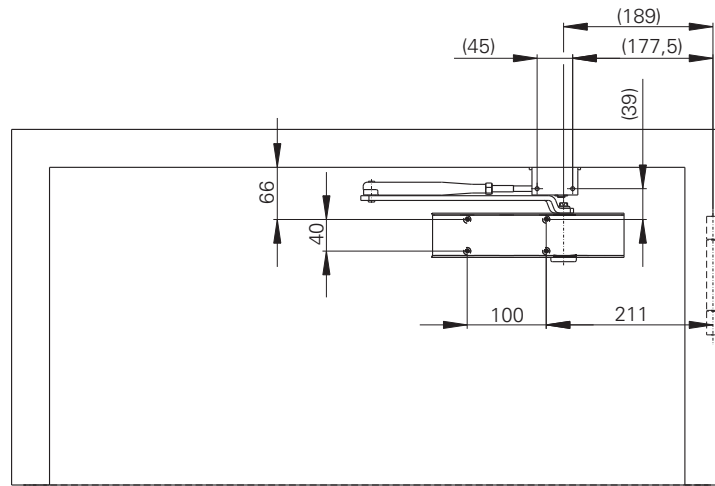
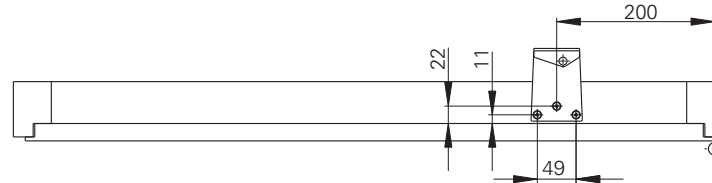

ohne Montageplatte / without mounting plate / sans plaque de montage

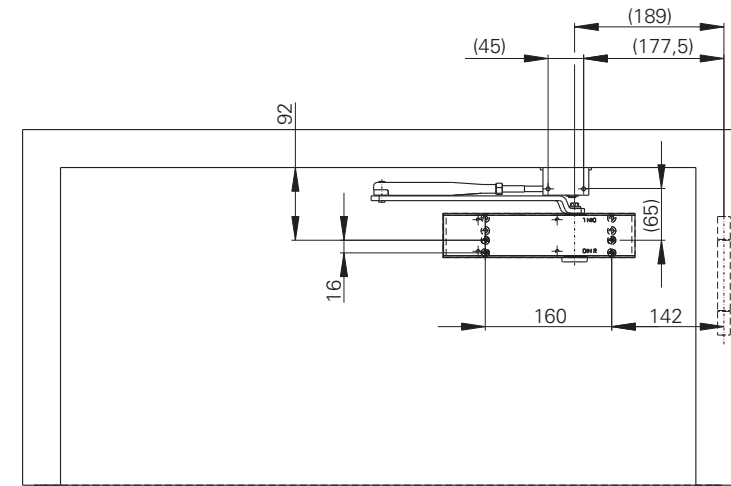

mit Montageplatte / with mounting plate / avec plaque de montage

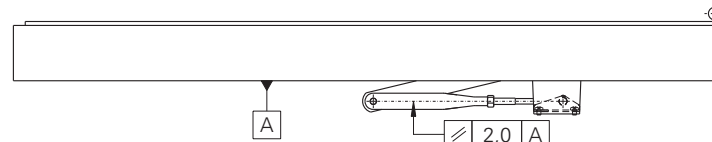

Leistungserklärung nach Verordnung (EU) Nr. 305/2011 finden Sie unter <http://www.eco-schulte.de/leistungserklaerungen>
 Declaration of performance according to Regulation (EU) No 305/2011 see <http://www.eco-schulte.de/declarationofperformance>
 Déclaration des performances conformément au règlement (UE) N° 305/2011 voir <http://www.eco-schulte.de/declarationdesperformances>