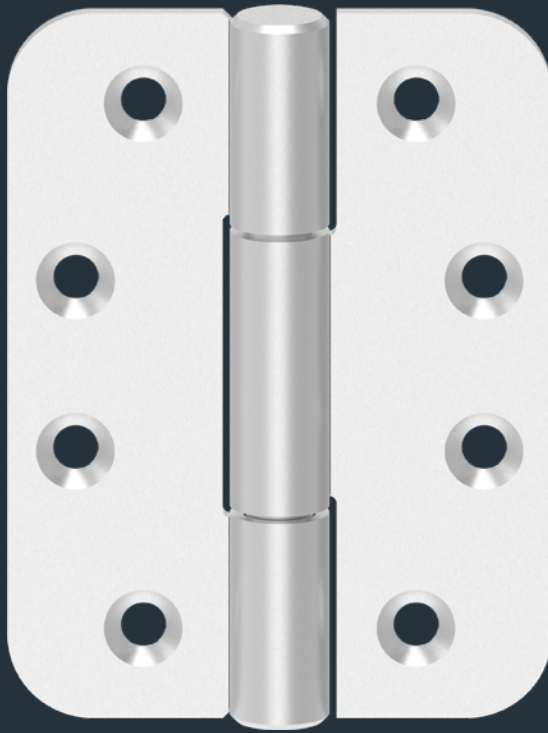
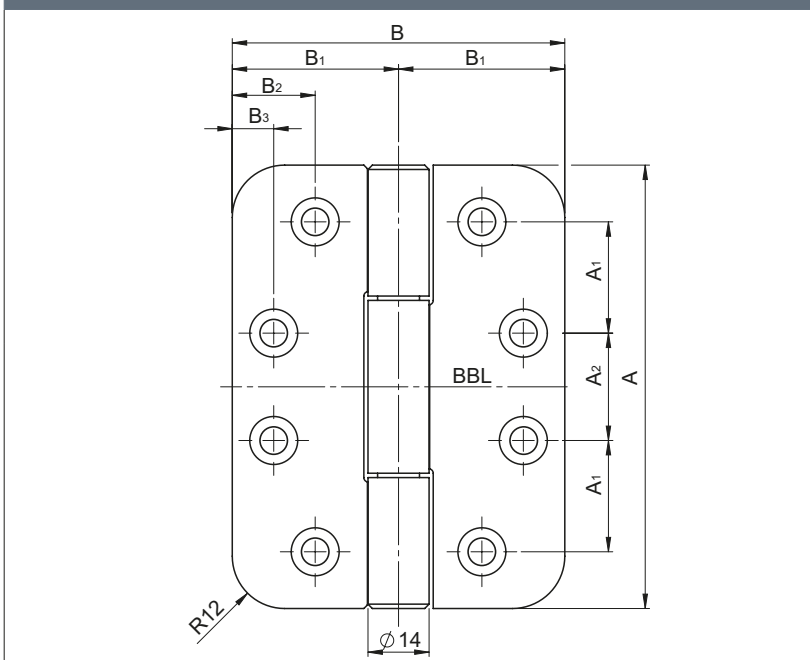
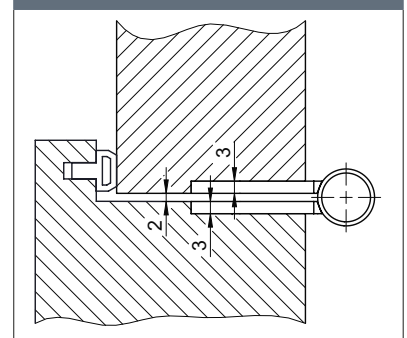

OBN-14-R-C

Performance criteria

| | | |
|-------------------------|------------------------------|---------|
| Ø knuckle | | 14 mm |
| Material thickness | | 3 mm |
| Screws | | M5 x 16 |
| DIN-L / DIN-R | | Yes |
| Mill diameter | | 24 mm |
| Hole pattern | C-shape | Yes |
| | Z-shape | - |
| Door types | Rebate | - |
| | Flush | Yes |
| Frame types | Wooden | Yes |
| | Steel | Yes |
| Suitable for fire doors | F | Yes |
| Load-bearing class 14 | EN 1935 CE | Yes |
| Door weight | according to standard | 160 kg |
| Material | Stainless steel (ER) | Yes |
| Finishes | ER matt brushed | Yes |
| | ER polished | - |
| | PVD coating | ■ |
| | Powder coating in RAL shades | ■ |

■ Yes - No ■ On request

Dimensional drawing

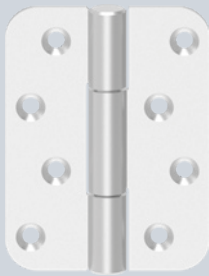
Cross-section

PRODUCT FAMILY ■ FOR FLUSH DOORS

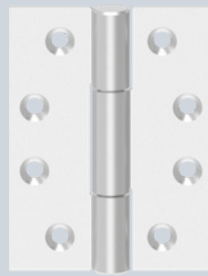
OBN-14-R-Z round Z hole pattern

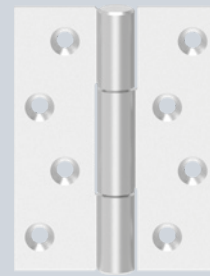

OBN-14-E-C rectangular C hole pattern

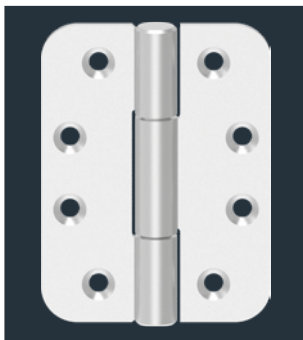

OBN-14-E-Z rectangular Z hole pattern

Description
ECO Horizon object hinge OBN-14-R-C round C hole pattern

- For flush doors on wooden and steel frames
- Concealed, fixed axis
- Patented wear- and maintenance-free ball bearing technology for absorbing radial and axial forces
- Suitable for use on FS doors
- DIN left/DIN right, can be used without conversion work
- Invisible axle connection (without cover head)





 Wooden door
  Steel door

| OBN-14-R-C round C hole pattern For flush doors | Dimensions A x B inch | Dimensions A x B inch | A ¹ mm | A ² mm | B ¹ mm | B ² mm | B ³ mm | Art. no. |
|---|--------------------------|--------------------------|-------------------|-------------------|-------------------|-------------------|-------------------|------------|
| OBN-14-4030-R-C.ER | 4 x 3 inch | 101.6 x 76.2 mm | 25.5 mm | 24.6 mm | 38.1 mm | 19 mm | 9.5 mm | On request |
| OBN-14-4035-R-C.ER | 4 x 3.5 inch | 101.6 x 88.9 mm | 25.5 mm | 24.6 mm | 44.45 mm | 19 mm | 9.5 mm | On request |
| OBN-14-4040-R-C.ER | 4 x 4 inch | 101.6 x 101.6 mm | 25.5 mm | 24.6 mm | 50.8 mm | 19 mm | 9.5 mm | On request |
| OBN-14-4540-R-C.ER | 4.5 x 4 inch | 114.3 x 101.6 mm | 28.6 mm | 31.3 mm | 50.8 mm | 25.4 mm | 9.5 mm | On request |
| OBN-14-5030-R-C.ER | 5 x 3 inch | 127 x 76.2 mm | 31.75 mm | 37.7 mm | 38.1 mm | 19 mm | 9.5 mm | On request |
| OBN-14-5035-R-C.ER | 5 x 3.5 inch | 127 x 88.9 mm | 31.75 mm | 37.7 mm | 44.45 mm | 25.4 mm | 9.5 mm | On request |
| OBN-14-5040-R-C.ER | 5 x 4 inch | 127 x 101.6 mm | 31.75 mm | 37.7 mm | 50.8 mm | 25.4 mm | 9.5 mm | On request |
| OBN-14-5050-R-C.ER | 5 x 5 inch | 127 x 127 mm | 31.75 mm | 37.7 mm | 63.5 mm | 25.4 mm | 9.5 mm | On request |

ECO Schulte GmbH & Co. KG

Iserlohner Landstraße 89

D-58706 Menden

Telephone +49 2373 9276 - 0

Telefax +49 2373 9276 - 40

info@eco-schulte.de

www.eco-schulte.de

Our compendium represents a compilation of all products from our range of services. These are subject to different delivery classes. Special variants included are often manufactured to customer specifications and sometimes require longer delivery times and minimum purchase quantities. Further advise can be given by your contact person.

■ SYSTEM TECHNOLOGY FOR THE DOOR

